

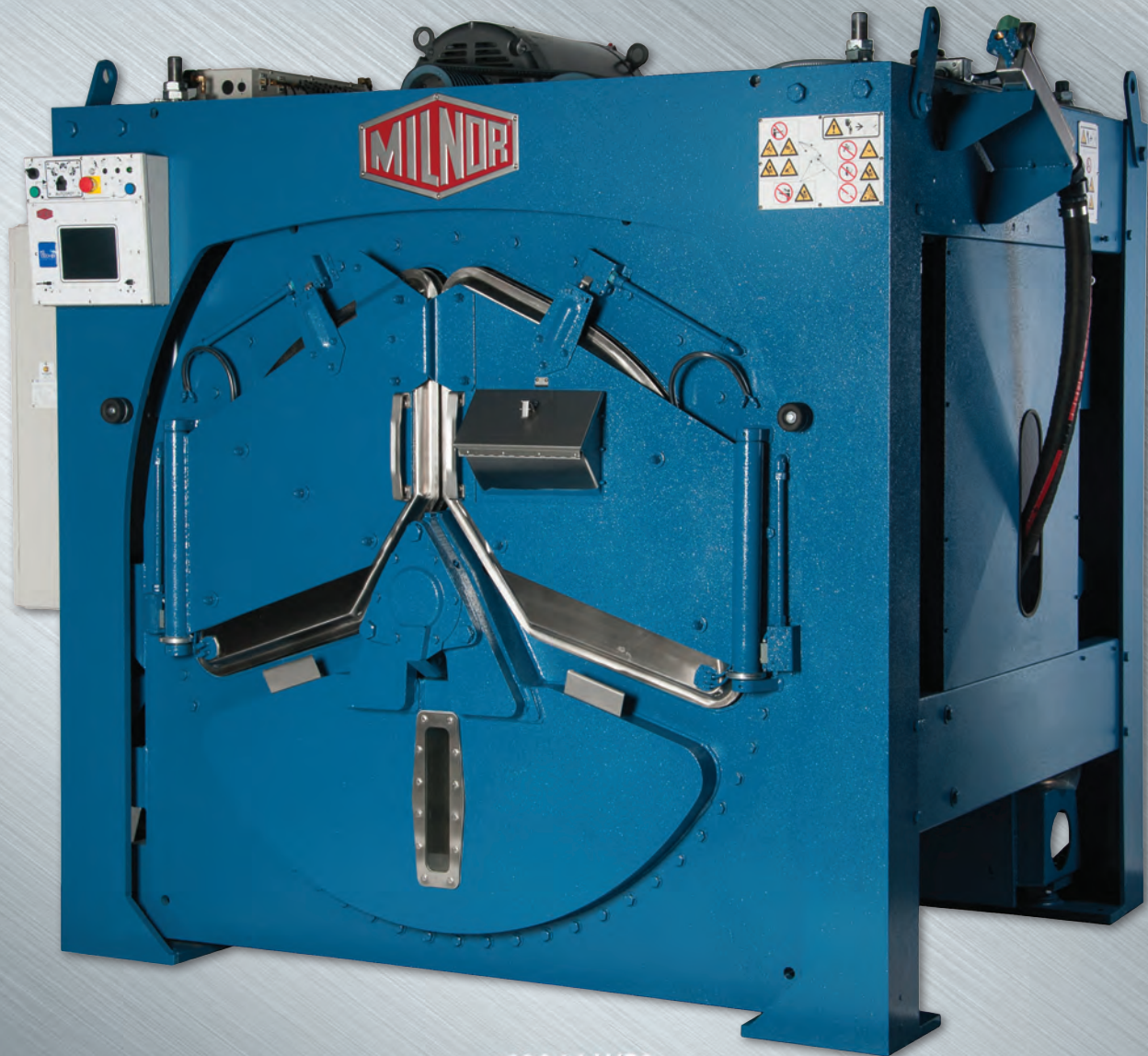

# DIVIDED-CYLINDER WASHER-EXTRACTORS

THREE CAPACITIES • STAPH GUARD® PASS-THROUGH DESIGN FOR HEALTHCARE



60044 WR2





# MILNOR DIVIDED-CYLINDER WASHER-EXTRACTORS



**42044 WR2**

Milnor's divided-cylinder washer-extractor's are designed to last. Available in either standard or Staph Guard® pass-through models, Milnor's compact and durable divided-cylinders are ideal for any laundry.

Now available with RinSave® water saver standard, these washers-extractors will save fresh water consumption, without compromising wash quality you expect from a Milnor.



**60044 SR2**

## **RAPID LOAD:** *Two pockets for higher productivity and superior wash quality*

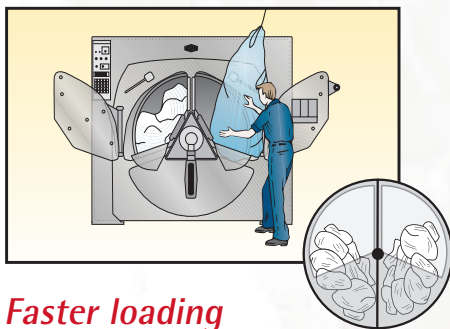

### **Faster loading**

Both pockets are open at one time for loading. (No need to load one pocket, close the doors, inch the cylinder, and then open another set of doors to load the other pocket.) Standard spray-down feature assists in faster loading. (See manual for details)

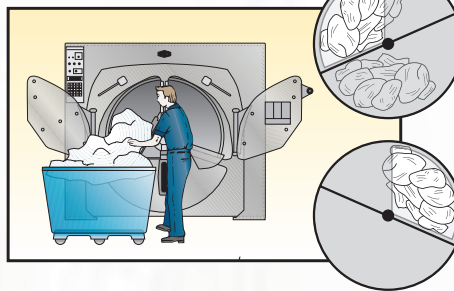

### **Faster Unloading**

For easy removal of goods, the load is fluffed by a tumble cycle after extraction. Then the cylinder is rotated to locate the load directly in front of the door - about 18° below horizontal for unloading. (With AUTOSPOT™, positioning is done automatically, in seconds).

The second pocket is unloaded just as easily by turning the cylinder to this position. AUTOSPOT does the job easily and accurately.



### **Better Washing Action**

RAPID LOAD's large 60-in. diameter cylinder - divided by only a single partition - provides greater dropping action for outstanding soil removal. Reversing action (note arrows) prevents tangling.

## **Accurate temperature control.**

Desired temperature can be programmed into each step of a formula — allowing infinite temperature settings.



## **Automatic supply injection promotes consistency.**

20 flushing liquid chemical ports and 15 signals provide flexibility. Optional 5 compartment flushing chemical chute available.

## **MILTOUCH-EX™ TOUCHSCREEN CONTROL**



The MilTouch-EX™ control is an enhanced version of the MilTouch™ control, which utilizes resistive touch screen technology

and full VGA resolution. The clear and informative display shows current machine status info including total, formula time, and time elapsed. With complete programming flexibility, MilTouch-EX™ touchscreen control formulas can be developed on a PC, saved

to USB external memory and uploaded with a screen touch. The control has intuitive fault diagnosis and relevant troubleshooting suggestions, which streamlines employee training and eliminates operator guesswork. The 15 chemical signals and MilTouch-EX™ control allow the user complete access to the machine's function at every level and wash/ rinse step (within safety limits). The MilTouch-EX™ control can be interfaced with specialized options such as metered water and integrated reuse tanks.



This exclusive software drives the basket toward a precise G-force that "slings" the wash liquor (including water, chemistry, and soil) out of the goods after a wash step.

This feature will save your laundry time, energy, and labor.



# STAPH GUARD® MACHINES

## PROVEN IN BARRIER LAUNDRIES WORLDWIDE

The Milnor STAPH GUARD® system is a thorough laundering system that combats recontamination of clean hospital laundry. Essential features are:

### 1. Barrier with pass-through machines.

A barrier completely separates the soiled laundry handling area from the clean laundry section. Installed in this barrier are STAPH GUARD® washer-extractors.

These machines are equipped with separate sets of doors - one set on the soiled side (for loading) and another set on the clean side (for unloading).

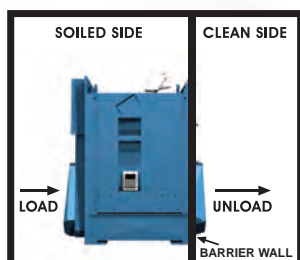

Clean side shown

### 2. StaphAIRTROL controls air flow.

StaphAIRTROL keeps bacteria-laden air from being discharged and recirculated in the clean laundry section.

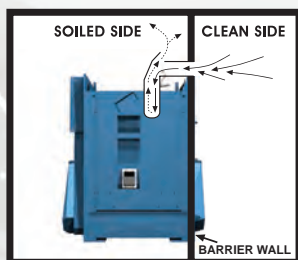

### 3. Safety interlocks.

Automatically-controlled door safety interlocks maintain the integrity of complete separation. Loading and unloading doors cannot be opened simultaneously.

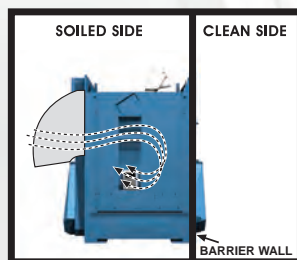

### 4. Positive/negative air pressure.

The entire hospital laundry should be designed to include positive pressure ventilation in the clean section and negative pressure ventilation in the soiled section.

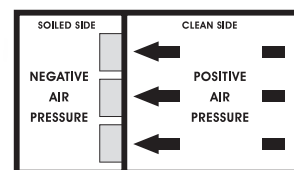

### HYDRO-CUSHION™ reduces objectionable vibration.

HYDRO-CUSHION™ is a unique suspension system designed to minimize objectionable vibration. It includes a rugged steel frame and spring-hydraulic units with heavy fluid damping.



### Large, low doors speed loading and unloading.

Loading and unloading doors on RAPID LOAD models are extra large for ease in handling.

### Rugged bearing mountings provide rigidity.

Large, high-capacity roller bearings are grease lubricated. Three seals shield bearings from the washing solution and keep oil and grease from entering the shell.

### Compact design saves space.

MILNOR design yields low, compact outer dimensions without sacrificing inner cylinder capacity - real space savers for laundries.

AUTOSPOT™ automatically locates the cylinder in precisely the right position each time for loading and unloading.

### Hygienic Processing Environment.

Milnor employs anti-microbial paint for structural components to promote a hygienic environment within the washer.



## SPECIFICATIONS

<b>DIVIDED-CYLINDER WASHER-EXTRACTORS</b>	<b>42044 WR2</b>		<b>60044 WR2</b>		<b>72044 WR2</b>	
Cylinder Volume - cu. ft. (L)	35	(991)	72	(2039)	104	(2945)
Capacity @ 6.3:1 lb./ft <sup>3</sup> (10:1 L/kg) - lb. (kg)	220	(100)	450	(205)	650	(295)
Capacity @ 7:1 lb./ft <sup>3</sup> (9:1 L/kg) - lb. (kg)	245	(111)	500	(227)	725	(330)
Cylinder diameter x depth - in. (mm)	42x44	(1067x1118)	60x44	(1524x1118)	72x44	(1829x1118)
Number of cylinder compartments	2	—	2	—	2	—
Single-motor drive - HP (kW)	25	(18.64)	50	(37.28)	—	—
Wash motor - HP (kW)	—	—	—	—	10	(7.45)
Drain speed motor - HP (kW)	—	—	—	—	7.5	(5.59)
Extraction motor - HP (kW)	—	—	—	—	20	(14.91)
Low speed extraction motor - HP (kW)	—	—	—	—	15	(11.18)
Approx. wash speed(s) (reversing 4 times/minute) - RPM	25-35 *	—	25-33 *	—	26	—
Approx. low speed extract - RPM	240 *	—	240 *	—	220	—
Maximum Extract speed - RPM (G forces)	735	(322)	625	(332)	535	(292)
Automatic drain valve - in. (mm)	8	(203)	8	(203)	10	(254)
Automatic inlet valves** - in. (mm)	1.5	(38)	2	(51)	2	(51)
Overall width *** - in. (mm)	89.25	(2267)	114.25	(2901)	119.75	(3041)
Overall depth *** - in. (mm)	70.2	(1783)	83.25	(2115)	84.5	(2146)
Overall height *** - in. (mm)	81.13	(2061)	93.96	(2387)	101.75	(2584)
Approx. net weight - lb. (kg)	5,700	(2585)	11,994	(5440)	17,260	(7829)

\* Programmable speeds. \*\* Equivalent flow rate \*\*\* With standard accessories. Contact Factory for information on 3 pocket variations. Capacity depends on density and soil content of goods. Specifications subject to change without notice.

<b>STAPH GUARD® WASHER-EXTRACTORS</b>	<b>42044 SR2</b>		<b>60044 SR2</b>		<b>72044 SR2</b>	
Cylinder Volume - cu. ft. (L)	35	(991)	72	(2039)	104	(2945)
Capacity @ 6.3:1 lb./ft <sup>3</sup> (10:1 L/kg) - lb. (kg)	220	(100)	450	(205)	650	(295)
Capacity @ 7:1 lb./ft <sup>3</sup> (9:1 L/kg) - lb. (kg)	245	(111)	500	(227)	725	(330)
Cylinder diameter x depth - in. (mm)	42x44	(1067x1118)	60x44	(1524x1118)	72x44	(1829x1118)
Number of cylinder compartments	2	—	2	—	2	—
Single-motor drive - HP (kW)	25	(18.64)	50	(37.28)	—	—
Wash motor - HP (kW)	—	—	—	—	10	(7.45)
Drain speed motor - HP (kW)	—	—	—	—	7.5	(5.59)
Extraction motor - HP (kW)	—	—	—	—	20	(14.91)
Low speed extraction motor - HP (kW)	—	—	—	—	15	(11.18)
Approx. wash speed(s) (reversing 4 times/minute) - RPM	25-35 *	—	25-33 *	—	26	—
Approx. low speed extract - RPM	240 *	—	240 *	—	220	—
Maximum Extract speed - RPM (G forces)	735	(322)	625	(332)	535	(292)
Automatic drain valve - in. (mm)	8	(203)	8	(203)	10	(254)
Automatic inlet valves** - in. (mm)	1.5	(38)	2	(51)	2	(51)
Overall width *** - in. (mm)	70	(1774)	89	(2261)	102	(2591)
Overall depth *** - in. (mm)	74.25	(1886)	83.5	(2121)	87.06	(2211)
Overall height *** - in. (mm)	82.15	(2087)	100.95	(2564)	109	(2769)
Approx. net weight - lb. (kg)	6,156	(2792)	12,074	(5477)	18,954	(8597)

Printed in U.S.A.  
© Pellerin Milnor Corporation  
Brochure B22SL00003/15086



Pellerin Milnor Corporation  
P.O. Box 400, Kenner, LA 70063-0400 USA  
504/712-7656 • 800/469-8780  
Fax: 504/468-3094  
E-mail: milnorinfo@milnor.com  
www.milnor.com